

**GARY MANOR HOMES**  
**DEMOLITION SERVICES**

11TH AVE & JEFFERSON ST  
 GARY, INDIANA 46408

PRIME CONSULTANT  
**Globetrotters**  
 Engineering Corporation

ENGINEERS - ARCHITECTS  
 300 S. Wacker Drive  
 Chicago, IL 60606  
 www.GEC-GROUP.com  
 312-922-6400

GLOBETROTTERS ENGINEERING CORPORATION ("GEC") RETAINS ALL PROPRIETARY RIGHTS AND COPYRIGHTS, STATUTORY AND COMMON LAW, TO THESE PLANS AND DESIGNS. USE OF THE DRAWINGS OTHER THAN FOR THEIR INTENDED PURPOSE, REPRODUCTION, ALTERATION, OR ASSIGNMENT TO ANY THIRD PARTY SHALL NOT OCCUR WITHOUT EXPRESS WRITTEN CONSENT BY GEC. GEC ASSUMES NO RESPONSIBILITY FOR ANY DRAWING NOT USED IN COMPLIANCE WITH THIS PARAGRAPH.

**ISSUANCES**

1	ISSUED FOR BIDS	09/24/21
2	ADDENDUM NO. 2	10/22/21
4	ADDENDUM NO. 4	11/03/21

NO.	DESCRIPTION	DATE
SEAL		
	DRAWN BY	NA/AK/MHL
	CHECKED BY	ML
	GHA NO.	2021-100-003
	GEC NO.	15013.001

SHEET TITLE  
**DEMOLITION SITE PLAN**  
 SHEET NUMBER  
**GM-D100**

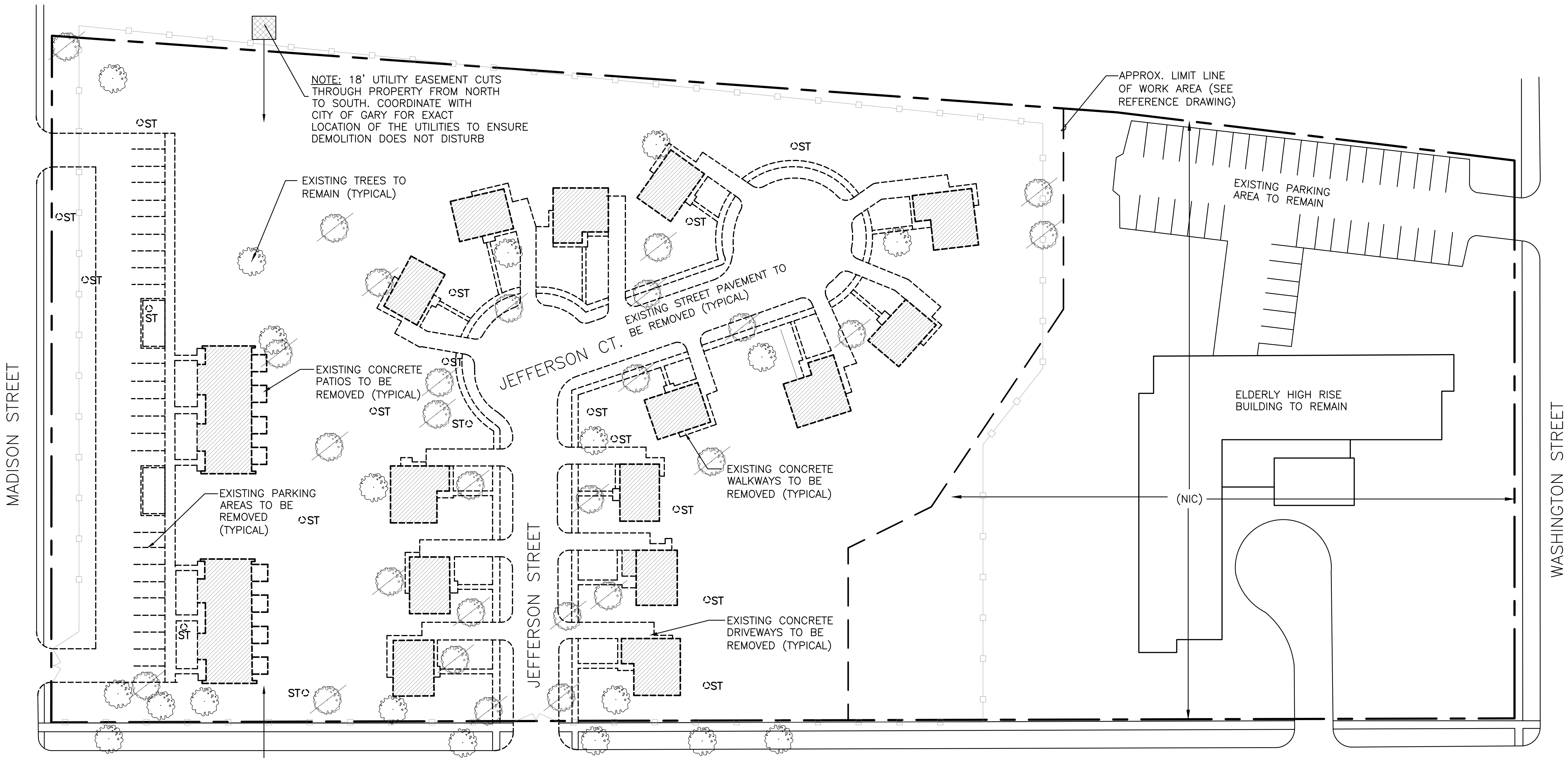

**1 DEMOLITION SITE PLAN**  
 SCALE: 1" = 30'-0"

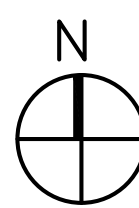

**LEGEND:**

- ONE OR TWO-STORY BUILDING/STRUCTURE TO BE DEMOLISHED. THERE ARE NO EXISTING BASEMENTS, FOUNDATION WALLS AND FOOTINGS TO BE REMOVED. BACKFILL ALL AREAS WITHIN DEMOLITION "FOOTPRINTS" IN ACCORDANCE WITH SPECIFICATIONS AND CODES UP TO A LEVEL OF 6" BELOW FINISHED GRADE.
- EXISTING CONCRETE WALKWAYS, CURBS, GUTTERS, DRIVEWAYS, DRIVEWAY APRONS, ASPHALT PARKING TO BE REMOVED. AGGREGATE UNDERNEATH AT EACH LOCATION DOES NOT NEED TO BE REMOVED. AFTER REMOVAL, ALL AREAS TO BE FILLED WITH TOP SOIL.
- EXISTING TREE TO REMAIN. CONTRACTOR IS TO PROVIDE TREE PROTECTION AND PROTECT ROOT SYSTEM; ONLY REMOVE A TREE IF IT IS DAMAGED BY FOUNDATION REMOVAL/DEMOLITION.
- REMOVE TREE INCLUDING STUMPS
- EXISTING TREE STUMP TO BE REMOVED (SIZE VARIES, VERIFY SIZE IN FIELD)
- FIRE HYDRANT TO BE REMOVED
- EXISTING FENCE

**ESTIMATED TREE COUNT\***

TREE DIAMETER	TREES TO REMAIN	TREES TO BE REMOVED
10" - 19"	6	14
20" - 29"	10	9
30" - 40"	3	4
<b>TOTAL COUNT</b>	<b>19</b>	<b>27</b>

\*CONTRACTOR TO VERIFY NUMBER AND SIZE



BY: nedhi.abraham  
 PLOT DATE/TIME: Nov 03, 2021 / 3:14pm  
 FILE: F:\projects\15013\001\VA\Sheet\091321\001-15013.000\_001\_D-1\_GARY MANOR DEMOLITION.dwg TAB: DEMOLITION SITE PLAN







**GARY MANOR HOMES**

**DEMOLITION SERVICES**

11TH AVE & JEFFERSON ST  
 GARY, INDIANA 46408

PRIME CONSULTANT  
**Globetrotters**  
 Engineering Corporation

ENGINEERS - ARCHITECTS  
 300 S. Wacker Drive  
 Chicago, IL 60606  
 www.GEC-GROUP.com  
 312-922-6400

GLOBETROTTERS ENGINEERING CORPORATION ("GEC") RETAINS ALL PROPRIETARY RIGHTS AND COPYRIGHTS, STATUTORY AND COMMON LAW, TO THESE PLANS AND DESIGNS. USE OF THE DRAWINGS OTHER THAN FOR THEIR INTENDED PURPOSE, REPRODUCTION, ALTERATION, OR ASSIGNMENT TO ANY THIRD PARTY SHALL NOT OCCUR WITHOUT EXPRESS WRITTEN CONSENT BY GEC. GEC ASSUMES NO RESPONSIBILITY FOR ANY DRAWING NOT USED IN COMPLIANCE WITH THIS PARAGRAPH.

ALL UNDERGROUND UTILITIES ARE TO BE REMOVED IN THEIR ENTIRETY UNLESS OTHERWISE INDICATED. CONTRACTOR IS RESPONSIBLE FOR LOCATING AND REMOVING ALL UTILITIES WITHIN THE PROPERTY THAT MAY OR MAY NOT BE SHOWN ON THIS DRAWING, UNLESS OTHERWISE NOTED

NOTE: 18' UTILITY EASEMENT CUTS THROUGH PROPERTY FROM NORTH TO SOUTH. COORDINATE WITH CITY OF GARY FOR EXACT LOCATION OF THE UTILITIES TO ENSURE DEMOLITION DOES NOT DISTURB

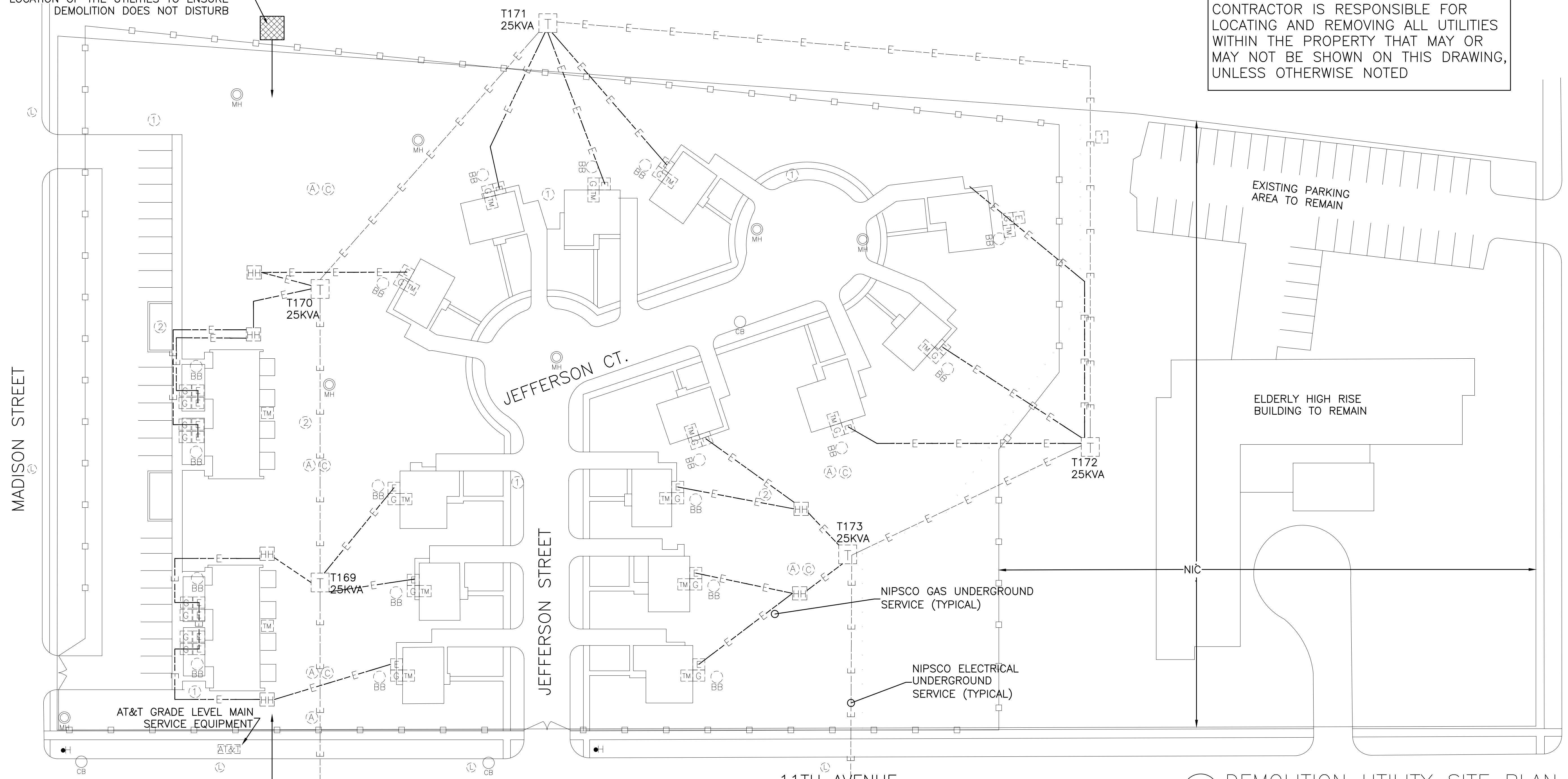

NOTE: 18' UTILITY EASEMENT CUTS THROUGH PROPERTY FROM NORTH TO SOUTH. COORDINATE WITH CITY OF GARY FOR EXACT LOCATION OF THE UTILITIES TO ENSURE DEMOLITION DOES NOT DISTURB

(OUT) NIPSCO POLE #196934 (IN) NIPSCO POLE #196933

1 DEMOLITION UTILITY SITE PLAN  
 SCALE: 1" = 30'-0"

**LEGEND:**

- ① ROUND METAL LIGHT POLE WITH ONE FIXTURE
- ② ROUND METAL LIGHT POLE WITH TWO FIXTURES
- ③ METAL 4"x4" LIGHT POLE WITH THREE FIXTURES
- Ⓐ AT&T GRADE LEVEL EQUIPMENT (SECONDARY)
- Ⓐ AT&T AT&T GRADE LEVEL EQUIPMENT (MAIN)
- Ⓔ INGROUND HANDHOLE
- ⓂH EXISTING MANHOLE AND RELATED PIPING TO REMAIN (CITY/UTILITY OWNED)
- Ⓒ COMCAST MAIN CABLE TV INTERNET SERVICE EQUIPMENT
- Ⓟ BUFFALO BOX
- Ⓝ NIPSCO ELECTRICAL UTILITY SOURCE
- Ⓐ AT&T AT&T GRADE LEVEL EQUIPMENT (MAIN)
- E— INGROUND ELECTRICAL CONDUIT
- FIRE HYDRANTS TO BE REMOVED INCLUDING UNDERGROUND FEED
- Ⓜ DWELLING BUILDING ELECTRICAL METER
- Ⓒ DWELLING BUILDING GAS METER
- Ⓜ DWELLING BUILDING TELEPHONE SERVICE
- EXISTING CATCH BASIN AND RELATED PIPING TO BE DEMOLISHED
- SOLID LINE AND SOLID CIRCLE DENOTE EXISTING TO REMAIN

GENERAL NOTES - UTILITIES	
1	TRENCH AND REMOVE ALL UNDERGROUND UTILITIES. CUT AND CAP AT PROPERTY LINE.
2	COORDINATE WITH NIPSCO AND ALL UTILITY COMPANIES. PRIOR TO THE START OF ANY WORK.
3	ALL METAL LIGHT POLES ARE FED VIA UNDERGROUND POWER.
4	ALL METAL POLES HAVE A 2'x2' CONCRETE BASE.
5	GC TO NOTIFY ALL UTILITY COMPANIES ON THE DISCONNECTION AND REMOVAL OF THEIR SERVICE EQUIPMENT.
6	MAIN GAS AND WATER LINE SHUT-OFF VALVE IS UNKNOWN. CONTRACTOR IS RESPONSIBLE FOR COORDINATING THE EXACT LOCATION OF THE MAIN GAS LINE VALVE.
7	EXISTING TELEPHONE AND CABLE TV TERMINAL SERVICE BOXES TO BE REMOVED IN THEIR ENTIRETY. CONTRACTOR TO CONFIRM WITH AT&T AND COMCAST PROVIDERS THAT THE TERMINAL SERVICE BOXES AND CABLES NO LONGER ARE NEEDED. NOTIFY GHA AND GEC REPRESENTATIVES IF SERVICES FOUND IN FIELD ARE STILL NEEDED TO PROVIDE SERVICES TO OTHER LOCATIONS THAT ARE NOT PART OF THE SCOPE OF WORK.
8	EXISTING FLOOR MOUNTED TRANSFORMERS TO BE REMOVED IN THEIR ENTIRETY. CONTRACTOR TO CONFIRM WITH NIPSCO THAT THE PRIMARY POWER FOR THIS LOCATION HAS BEEN COMPLETELY TURNED OFF PRIOR TO THE START OF ANY WORK. NOTIFY GHA AND GEC REPRESENTATIVES IF POWER IS STILL ACTIVE AT THIS LOCATION.

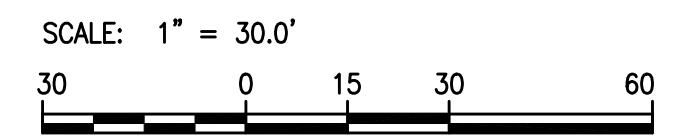

ISSUANCES		
1	ISSUED FOR BIDS	09/24/21
△	ADDENDUM NO. 2	10/22/21
△	ADDENDUM NO. 4	11/03/21

NO.	DESCRIPTION	DATE
SEAL		
	DRAWN BY	NA/AK/MHL
	CHECKED BY	ML
	GHA NO.	2021-100-003
	GEC NO.	15013.001

SHEET TITLE

**DEMOLITION UTILITIES**

SHEET NUMBER  
**GM-U200**

BY: nedhi.abraham  
 PLOT DATE/TIME: Nov 03, 2021 / 3:14pm  
 FILE: F:\projects\15013\001\VA\Sheet\091321\002-15013.000\_001\_U-2\_GARY MANOR\_UTILITIES.dwg TAB: GM-U200



**GARY MANOR HOMES**  
 11TH AVENUE & JEFFERSON ST  
 GARY, INDIANA 46408

GHA NO. 2021-100-003

REVISIONS		
NO.	DESCRIPTION	DATE
1	ISSUED FOR BIDS	09/24/21
2	ADDENDUM NO. 2	10/22/21
4	ADDENDUM NO. 4	11/03/21

DRAWN BY: - NA/AK  
 CHECKED BY: - JMS  
 APPROVED BY: - JMS  
 DRAWN DATE: -

WARNING: ASBESTOS-CONTAINING BUILDING MATERIALS ARE OR MAY BE PRESENT IN THIS BUILDING. AN ASBESTOS MANAGEMENT PLAN IS AVAILABLE IN THE SCHOOL FOR REVIEW UPON REQUEST. NO PERSON MAY DISTURB ASBESTOS-CONTAINING MATERIALS UNLESS THAT PERSON IS A LICENSED ASBESTOS WORKER OR CONDUCTS SUCH WORK IN ACCORDANCE WITH SPECIFICATIONS(S) CONTAINED IN THE PROJECT DOCUMENTS AND IN COMPLIANCE WITH ILLINOIS DEPARTMENT OF HEALTH RULES AND REGULATIONS.

**ABATEMENT PLAN**

SHEET NUMBER:

**GM-ABT-1**

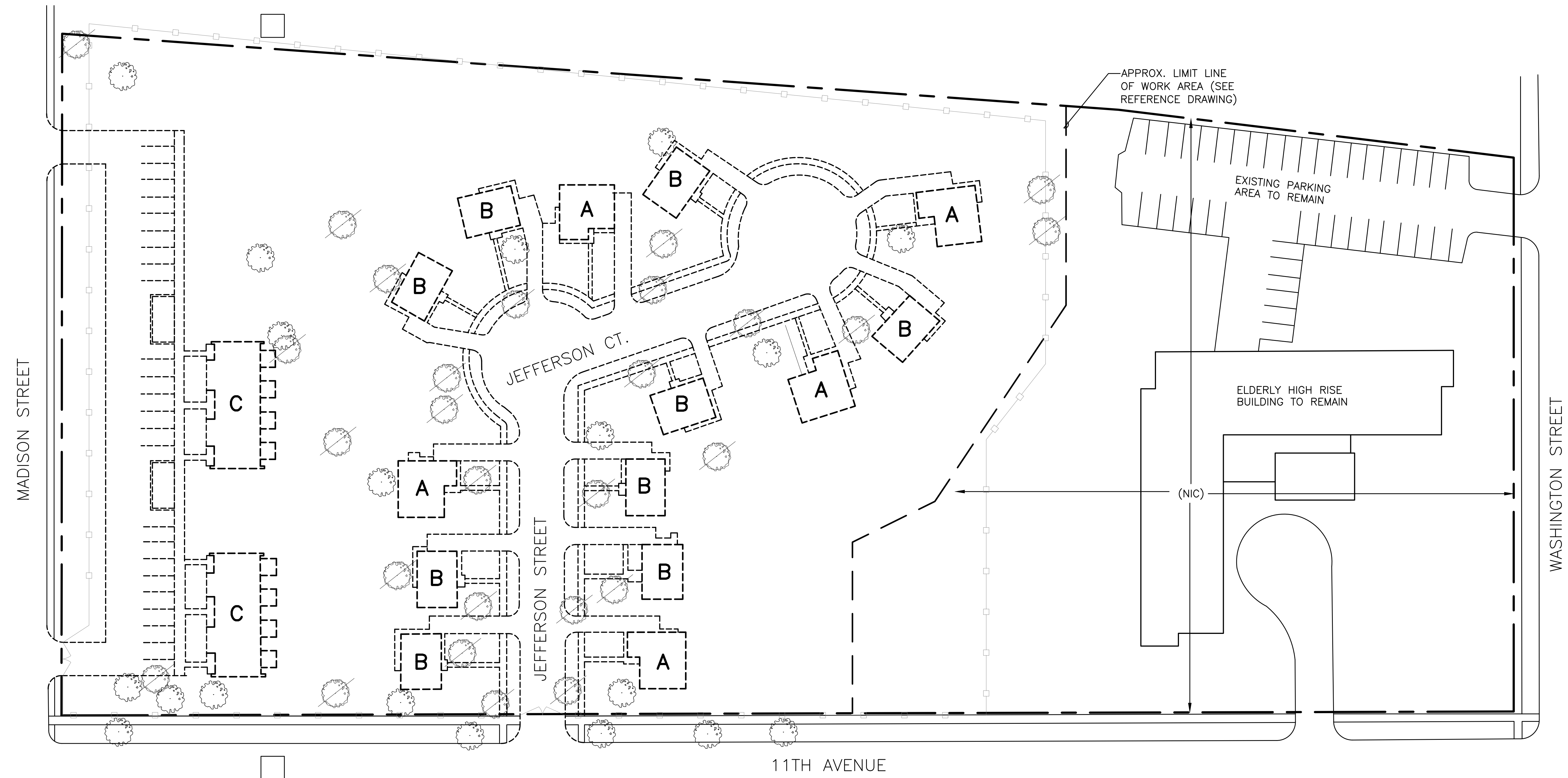

**1 SITE PLAN WITH BUILDING TYPES A,B,C**  
 SCALE: 1" = 60'-0"

BLDG TYPE	NO. OF BLDGS
A	5
B	9
C	2

NOTE:  
 BUILDING TYPES A, B, C ARE DWELLING BUILDINGS.  
 THERE ARE NO NON-DWELLING BUILDINGS.

NOTE:  
 THE SUMMARY OF HAZARDOUS MATERIALS TABLE I & II SHOWN ON THIS DRAWING ARE ALSO INCLUDED IN THE SPECIFICATIONS APPENDIX.

TABLE I - ASBESTOS CONTAINING MATERIALS			
Material Description	Material Location	*Estimated Quantity	Comments
12" x 12" Floor tile and Mastic	Throughout	25,600 SF	1 - 3 Layers of Floor tile
Drywall System	Throughout	128,000 SF	
<i>*All Quantities Are Approximate And Provided For Convenience Only. Contractor To Confirm All Quantities Prior To Bidding. Change Order Will Not Be Approved Due To Incorrect Quantity Estimating.</i>			

TABLE II - OTHER HAZARDOUS MATERIALS			
Material Description	Material Location	*Estimated Quantity	Comments
Mercury Thermostats	Throughout	25 EA	
Potential PCB Circuit Breakers	Throughout	25 EA	
Potential PCB Electrical Meters	Throughout	25 EA	
Unknown liquid in pantry next to bathroom - 2nd Floor	1043 Madison	3 Jars	
<i>*All Quantities Are Approximate And Provided For Convenience Only. Contractor To Confirm All Quantities Prior To Bidding. Change Order Will Not Be Approved Due To Incorrect Quantity Estimating.</i>			

GENERAL ABATEMENT NOTES	
1	ASBESTOS ABATEMENT WORK SHALL BE PERFORMED IN ACCORDANCE WITH THE CONTRACT DOCUMENTS AND ALL APPLICABLE FEDERAL, STATE, AND LOCAL REGULATIONS INCLUDING BUT NOT LIMITED TO OSHA, NESHAP, AND IDEM REGULATIONS. MOST STRINGENT METHOD TO BE UTILIZED WHEN THERE IS CONFLICT REGARDING ANY SPECIFIED METHOD.
2	ESTIMATED QUANTITIES OF ASBESTOS CONTAINING MATERIALS (ACM) AND OTHER HAZARDOUS MATERIALS ARE PROVIDED IN THE SPECIFICATION APPENDICES. HOWEVER, THE CONTRACTOR IS RESPONSIBLE FOR VERIFYING THE QUANTITIES OF ALL ACM IN THE FIELD BEFORE BIDDING. THE CONTRACTOR SHALL BE RESPONSIBLE FOR COMPLETE REMOVAL OF ALL ACM.
3	CONTRACTOR SHALL NOT COLLECT SAMPLES OF ANY MATERIAL TO VERIFY THE ASBESTOS CONTENT OF THE MATERIAL. ANY QUESTION ABOUT THE SCOPE OR VERIFICATION SHALL BE OBTAINED IN WRITING PRIOR TO BIDDING.
4	CONTRACTOR SHALL NOT PERFORM ANY ENVIRONMENTAL MITIGATION AND/OR ABATEMENT WORK WHEN OCCUPANTS ARE PRESENT. WHEN THE PREMISES ARE OCCUPIED, THE CONTRACTOR SHALL PROVIDE APPROPRIATE SEPARATION BARRIERS TO ENSURE THE SAFETY OF OCCUPANTS.
5	ELECTRICAL SYSTEM AND COMPONENTS IN THE WORK AREA SHALL BE SHUT DOWN AND LOCKED OUT FOR THE DURATION OF PROJECT. CONTRACTOR SHALL PROVIDE TEMPORARY POWER FROM OUTSIDE SOURCE EQUIPPED WITH GROUND-FAULT CIRCUIT INTERRUPTER AT THE SOURCE.
6	ALL ASBESTOS ABATEMENT SHALL BE CONDUCTED USING WET METHODS UNDER NEGATIVE PRESSURE. NO DRY REMOVAL SHALL BE PERMITTED. NO VISIBLE EMISSION FROM WORK AREA SHALL BE PERMITTED.
7	ALL LAYERS OF VINYL FLOOR TILE AND MASTIC (INCLUDING ALL NON-ACM LAYERS BETWEEN FLOOR TILES AND MASTIC AND/OR MATERIALS, IF ANY) SHALL BE REMOVED AS ACM.

